

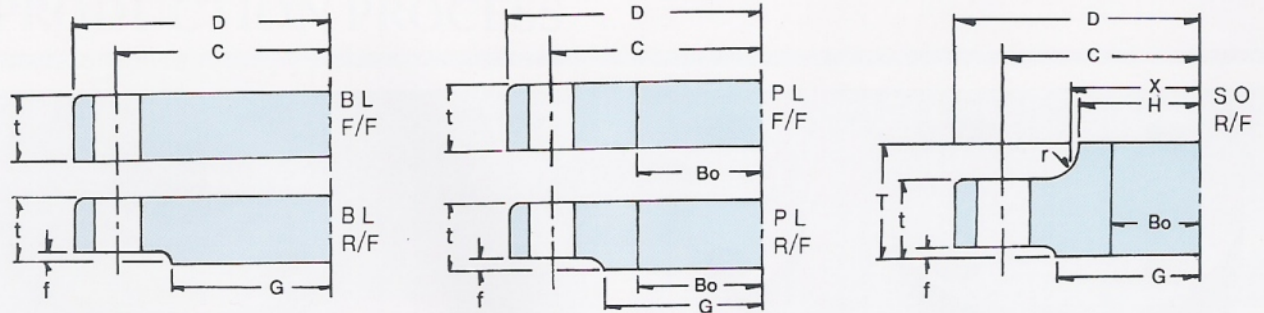

JIS FLANGES JIS 16kg/cm²

STEEL PIPE FLANGES



[16K]-1

(Dimensions in mm)

PIPE		PIPE	Bo	(2)	D	(2)	t	(2)	T	(2)	G	(2)
B	A											
3/8	10	17.3	17.8		90		12		16		48	
1/2	15	21.7	22.2		95		12		16		52	
3/4	20	27.2	27.7		100		14		20		58	
1	25	34.0	34.5		125		14		20		70	
1 1/4	32	42.7	43.2	+ 0.5	135		16	+ 1.0	22		80	
1 1/2	40	48.6	49.1	- 0	140	+ 1.0	16		24		85	± 0.8
2	50	60.5	61.1		155	- 0	16		24		100	
2 1/2	65	76.3	77.1		175		18		26		120	
3	80	89.1	90.0		200		20		28		135	
3 1/2	90	101.6	102.6		210		20		30	± 1.0	145	
4	100	114.3	115.4		225		22		34		160	
5	125	139.8	141.2		270		22		34		195	
6	150	165.2	166.6		305		24		38		230	
7	175	190.7	192.1	+ 1.0	325		26		40		250	
8	200	216.3	218.0	- 0	350	+ 1.5	26		40		275	
9	225	241.8	243.7		385	- 0	26		40		325	
10	250	267.4	269.5		430		28		44		345	± 0.9
12	300	318.5	321.0		480		30	+ 1.5	48		395	
14	350	355.6	358.1		540		34	- 0	52		440	
16	400	406.4	409.0		605		38		60		495	
18	450	457.2	460.0	+ 1.5	675		40		64		560	
20	500	508.0	511.0	- 0	730	+ 2.0	42		68		615	
22	550	558.8	562.0		795	- 0	44		70		670	
24	600	609.6	613.0		845		46		74		720	
26	650	660.4	664.0	+ 2.0	895		48		77	± 1.5	770	
28	700	711.2	715.0	- 0	960		50		80		820	± 1.0
30	750	762.0	766.0		1020		52		83		880	
32	800	812.8	817.0		1085		54		86		930	
34	850	863.6	868.0	+ 2.5	1135	+ 2.5	56		89		980	
36	900	914.4	919.0	- 0	1185	- 0	58		93		1030	
40	1000	1016.0	1021.0		1320		62	+ 2.0	99		1140	
44	1100	1117.6	1123.0		1420		66	- 0	105		1240	
48	1200	1219.2	1225.0	+ 3.0	1530	+ 3.0	70		112		1350	± 1.2
52	1300	1320.8	1326.0	- 0	1645	- 0	74		-	± 2.0	1450	
54	1350	1371.6	1377.0		1700		76		-		1510	
56	1400	1422.4	1428.0		1755		78		-		1560	
60	1500	1524.0	1529.0		1865		80		-		1670	

JIS FLANGES JIS 16kg/cm²

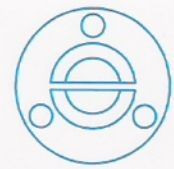

STEEL PIPE FLANGES

BLIND

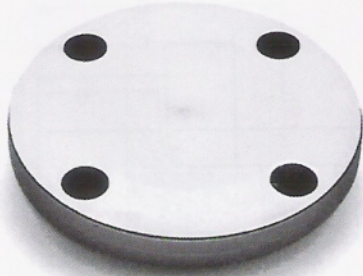

PLATE

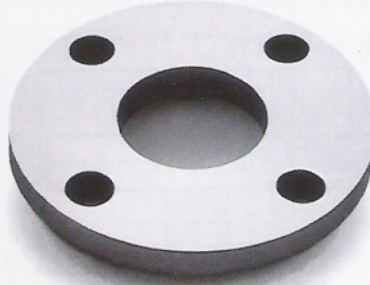

SLIP-ON



[16K]-2

(Dimensions in mm)

f	r	H	(2)	X	(2)	C	(2)	Number of Holes	Bolt Diameter	kg/pc		
										PL	SO	BL
1	4	26		28		65		4	15	0.5	0.5	0.6
1	4	30		32		70		4	15	0.6	0.6	0.6
1	4	38		42		75		4	15	0.7	0.8	0.8
1	4	46		50		90		4	19	1.2	1.2	1.3
2	5	56		60		100		4	19	1.5	1.6	1.7
2	5	62		66	+ 1.0	105		4	19	1.6	1.7	1.8
2	5	76	+ 1.0	80	- 0	120	± 0.5	8	19	1.7	1.8	2.1
2	5	94	- 0	98		140		8	19	2.4	2.6	3.1
2	6	108		112		160		8	23	3.5	3.7	4.5
2	6	120		124		170		8	23	3.7	4.0	5.0
2	6	134		138		185		8	23	4.5	4.9	6.3
2	6	164		170		225		8	25	6.5	7.0	9.2
2	6	196		202		260		12	25	8.7	9.6	12.8
2	6	216		222		280		12	25	10.7	10.9	16.5
2	6	244		252		305		12	25	10.9	12.1	18.6
2	6	266		272	+ 1.5	335	± 0.6	12	27	13.9	14.1	23.1
2	6	304	+ 1.5	312	- 0	380		12	27	18.0	20.0	30.6
3	8	354	- 0	364		430		16	27	21.5	24.4	40.7
3	8	398		408		480		16	33	30.8	35.0	57.8
3	10	446		456		540		16	33	42.8	46.2	82.2
3	10	504		514	+ 2.0	605		20	33	55.1	61.9	107.6
3	10	558	+ 2.0	568	- 0	660		20	33	65.1	73.3	133.1
3	10	612	- 0	622		720		20	39	77.9	88.1	164.1
3	10	666		676		770	± 0.8	24	39	86.0	98.8	193.2
5	10	704	+ 2.5	726	+ 2.5	820		24	39	96.3	101.0	227.5
5	10	754	- 0	776	- 0	875		24	42	114.1	120.0	272.6
5	10	806		832		935		24	42	132.7	141.0	321.9
5	10	865		885		990		24	48	152.1	161.0	375.6
5	10	916	+ 3.0	936	+ 3.0	1040		24	48	166.5	177.0	428.1
5	10	968	- 0	986	- 0	1090	± 1.0	28	48	178.1	191.0	481.8
5	12	1070		1098		1210		28	56	235.3	230.0	636.0
5	12	1180		1200		1310		32	56	267.9	289.0	784.0
5	12	1282		1302		1420		32	56	321.1	348.0	972.4
5	-	-	+ 3.5	-	+ 3.5	1530		32	62	378.6	-	1185.2
5	-	-	- 0	-	- 0	1590	± 1.5	32	62	410.0	-	1303.8
5	-	-		-		1640		36	62	436.0	-	1422.5
5	-	-		-		1750		36	62	496.4	-	1656.6